

NEW APS 620

COMPACTNESS AND
EASY INSTALLATION



APS 620 ERGON



ULTRA-COMPACT FRAME

The compact and ergonomic structure ensures great space saving inside the bottling line and allows the operator to easily and safely carry out all the activities related to the use, cleaning and maintenance operations of the plant.



IMMEDIATE INSTALLATION AND EASY MAINTENANCE

The electric panel represents a distinct module that remains cabled during transport and therefore can be installed immediately at the customer's plant. This results in a great simplification of the machine set up. Moreover, the TCO (Total Cost of Ownership) is optimized thanks to low operating and maintenance costs.



FLEXIBILITY AND CUSTOMIZATION

This palletizing system enables to create several palletizing patterns according to the specific requirements of the customer (up to 30 palletizing schemes can be managed).



TOP OPERATIONAL PRECISION

The machine axes are controlled by brushless motors that ensure highly dynamic, smooth and precise movements. Precision in movement is also ensured by the installation of a gripping head depending on the product handled: the side gripping head is suitable for any type of pack, the vacuum gripping head is used for products in boxes and the magnetic head is appropriate for metal containers.



ENERGY EFFICIENCY

This machine represents an eco-friendly solution, thanks to the use of ICOS motors with built-in servo drives, capable of simplifying the machine wiring and ensuring greater energy efficiency, low noise level and reduced component wear.



SMI S.p.A.
Via Carlo Ceresa, 10 I-24015 San Giovanni Bianco (BG)
Tel.: +39 0345 40.111 - Fax: +39 0345 40.209
info@smigroup.it - www.smigroup.it



LIMITED SIZE, ENDLESS ADVANTAGES

A compact palletizer, suitable for low-speed productions (up to 20 packs/minute and 60 layers/hour), easy to be installed and characterized by simplified maintenance: these have been the premises for the development of the APS 620 ERGON palletizer, a solution for the tertiary packaging designed to optimize the end-of-line operations of companies of different sectors (food, beverage, detergent, chemical and pharmaceutical industry are just some examples). By integrating the machine main functions into the central column, these fully automatic palletizing systems are extremely compact and easily adaptable to any logistic condition of the end-of-line area, both in existing plants and new installations. For the official presentation of this solution, SMI has chosen Interpack, the world's leading international trade fair for the packaging sector and an event that reflects the flexibility and the spirit of innovation that the new palletizing system also embeds.



APS 620
VIDEO
scan this QR code

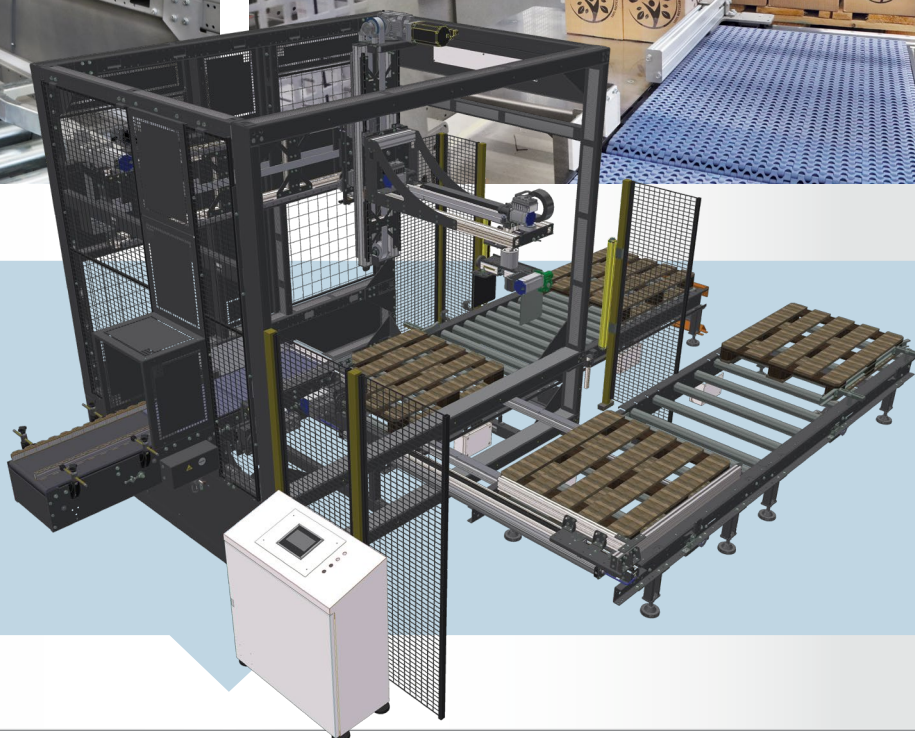

SMI S.p.A.
Via Carlo Ceresa, 10 I-24015 San Giovanni Bianco (BG)
Tel.: +39 0345 40.111 - Fax: +39 0345 40.209
info@smigroup.it - www.smigroup.it